

Knitting Machine

Basic Instructions



Visual Learner? Check out this Video!



Setup

1. Set the knitting machine near the edge of a table with two of the machine's legs parallel with the edge.
2. Use the table clamps to hook around the legs, then tighten the clamp around the table side.
3. Use the spinning dial to reset the Row Counter to 0000
4. Decide on which style of knitting, Flat or Circular and set the red lever accordingly (Up for Flat, Down for Circular)

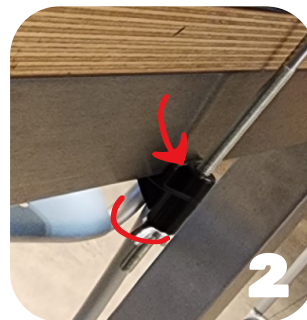

STEP 1: Cast On

For Flat Knit

1. Rotate the crank **counter-clockwise** until you reach the three black hooks, make sure the leftmost of the three hooks is risen up. (NOTE: While set to Flat Knitting mode, The black hooks will give resistance, **DO NOT** force the machine to go further than it allows)
2. Wrap your Yarn around this hook with the tail end on your right side. Make sure the tail is long enough to where it touches the table in the middle.
3. Slowly rotating the crank clockwise, thread your yarn in front of and behind the hooks.
4. As you approach the black hooks once more, wrap behind the last white hook and pass the Yarn through the Gold Yarn Shuttle.
5. Now you're ready to Knit!

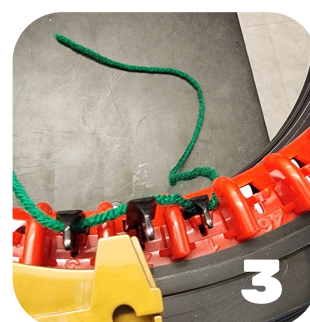

Ready!



STEP 1: Cast On

For Circular/Round Knit

1. Rotate the crank counter clockwise until you reach the three black hooks, make sure the rightmost of the three hooks is risen up.
2. Wrap your Yarn around this hook with the tail end on your right side. Make sure the tail is long enough to where it touches the table in the middle.
3. Slowly rotating the crank clockwise, thread your yarn in front of and behind the hooks.
4. As you approach the black hooks once more, wrap behind the last white hook and pass the Yarn through the Gold Yarn Shuttle.
5. Now you're ready to circular Knit!

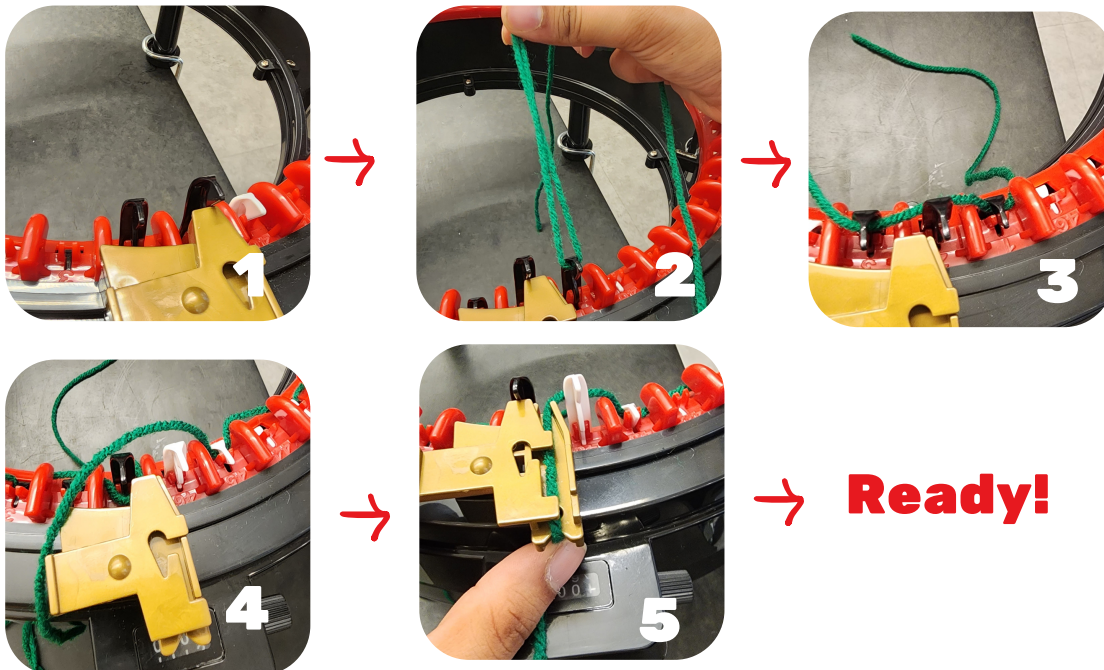

STEP 2: Knitting

For Flat Knit

1. From the Starting Position rotate the crank clockwise until the machine provides resistance and the crank will no longer turn.
2. Now rotate the crank counter-clockwise until the machine provides resistance and the crank will no longer turn.
3. **DO NOT** force the crank to turn when the machine gives resistance.
4. Repeat this process alternating between rotating clockwise and counter clockwise until the desired length is reached.

For Round Knit

1. From the Starting Position rotate the crank clockwise.
2. The row counter will click every time a rotation is complete, that is, the black hooks pass the shuttle.
3. Repeat this process until the desired length is reached.

Quick Reference



Flat Knit: Alternating Clockwise and Counter Clockwise.



Circular Knit: Continuous Clockwise Rotation.



STEP 3: Cast Off

Note: Due to the design of the machine, this method of cast off still leaves the end yarn quite loose and cinches the work when pulled. As such it is highly recommended that you use standard knitting needles to bind off your project.

Flat Knitting

1. Rotate the Crank Counter Clockwise to the farthest it will go.
2. Remove the Yarn from the shuttle and measure out approximately 35in of Yarn from the shuttle to your ball and cut it.
3. Thread this Yarn into the Red Curved needle in the kit.
4. Working Slowly Clockwise, insert the needle into each stitch alternating between entering the stitch from in front and from behind. Pick the stitch off the machine once you've passed your needle through it. (NOTE: Make sure the hook is fully hidden before you stitch, also be sure to use the two red plastic bits to guide your needle.)
5. And Voila! Your piece is complete!

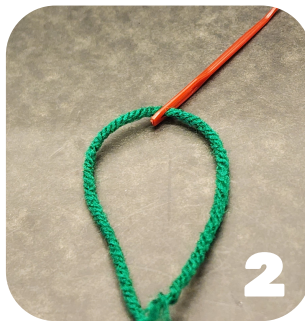
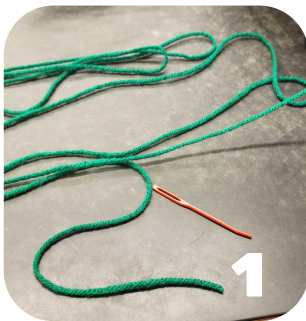

STEP 3: Cast Off

Note: Due to the design of the machine, this method of cast off still leaves the end yarn quite loose and cinches the work when pulled. As such it is highly recommended that you use standard knitting needles to bind off your project.

Circular/Round Knitting

1. Rotate the Crank Counter Clockwise until the rightmost black hook is risen up.
2. Remove the Yarn from the shuttle and measure out approximately 35in of Yarn from the shuttle to your ball and cut it.
3. Thread this Yarn into the Red Curved needle in the kit.
4. Working Slowly Clockwise, insert the needle into each stitch alternating between entering the stitch from in front and from behind. Pick the stitch off the machine once you've passed your needle through it. (NOTE: Make sure the hook is fully hidden before you stitch, also be sure to use the two red plastic bits to guide your needle.)
5. And Voila! Your piece is complete!

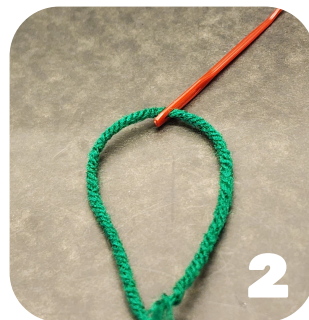

Extra Skills

Multicolor Knits

1. When Knitting with two colors, knit to your desired length with one color.
 2. Leave around three inches of working yarn outside the shuttle and cut.
 3. Tie the end of your previous color to the working end of your new color.
 4. Make sure the knot is tight, such that it doesn't come apart while in the machine. (NOTE: A tight overhand knot is ideal, DO NOT Slipknot this)
 5. This Process can be repeated as long as needed.
-

Need Some More Help?

Here are more tutorials!



[Flat Knitting Tutorial](#)



[Cast Off Tutorial](#)

Viewing the PDF Version? These are Links!

